

Follow this easy guide and connect your portables to the TV for great picture and sound.

TV Viewing

PRESS this button to return to regular TV viewing.

AC Outlets

Easy access AC outlet

Xbox®



XBox 360®



PlayStation®



PlayStation®

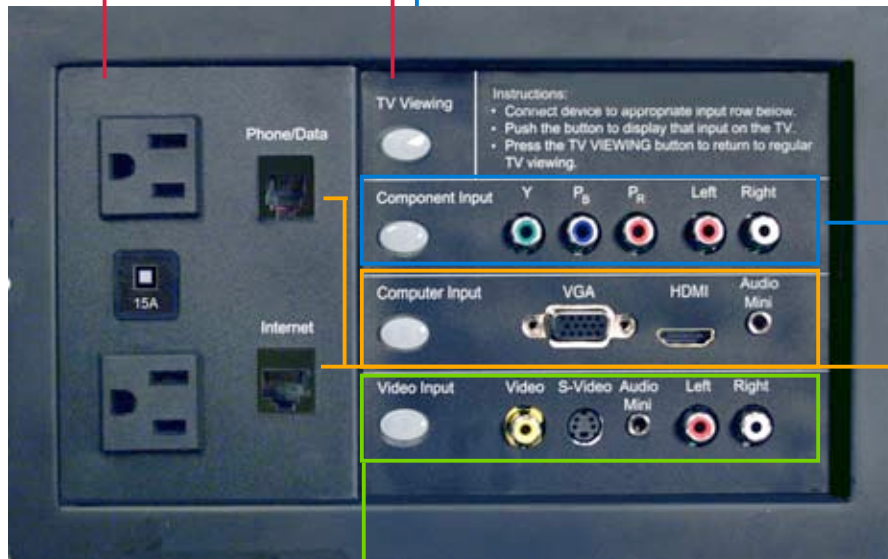

Component Inputs

Connections for high-definition power games

JACKS Y, P_B, P_R – Plug game system cables to view on TV

JACKS Left, Right – Plug game system audio cables to hear the game on the TV

PRESS Component Input button to view and hear your game

Computer Inputs

Connections for your computer



Laptop

Video Inputs

Connections for a variety of devices

Video JACK – Connect using a video cable to view the device on the TV screen

- Portable DVD Player
- Camcorder
- Digital Camera
- Xbox (in standard definition)
- PlayStation 2 (in standard definition)
- GameCube™ (in standard definition)

Audio Mini JACK – Connect using an audio mini cable to hear the device on the TV

- MP3 Players

JACKS Left, Right – Plug audio cable to hear the device on the TV

- Portable DVD Player
- Video iPod®
- Camcorder
- Microsoft Zune™

PRESS Video Input button to view and hear your device

Standard Definition
Game Systems



Digital Cameras



Camcorders



Portable DVD Players



MP3 Players
Audio & Video

VGA JACK

Connect using a VGA cable

HDMI JACK – Connect using an HDMI cable

- Also Supports PlayStation 3

Audio Mini JACK – Connect using an audio mini cable

Phone/Data JACK – Use a phone cord to connect to the phone jack on the laptop

Internet JACK – Use a CAT-5 cable to connect to the Ethernet jack on the laptop

PRESS Computer Input button to view and hear your laptop on the TV